

# CLARKE®



## LED WORKLIGHT(230V)

MODEL NO: SMD5000

PART NO: 4003545

### ASSEMBLY & USER INSTRUCTIONS

UK  
CA

CE



ORIGINAL INSTRUCTIONS

GC0724

---

## INTRODUCTION

---

Thank you for purchasing this CLARKE portable LED worklight which can be used either indoors or outdoors. Before attempting to use this product, please read this manual thoroughly and follow the instructions carefully. In doing so you will ensure the safety of yourself and that of others around you, and you can look forward to your purchase giving you long and satisfactory service.

---

## TECHNICAL INFORMATION

---

| <b>Model</b>                 | <b>SMD5000</b>               |
|------------------------------|------------------------------|
| Dimensions (W x D x H)       | 670 x 520 x 1136 mm (opened) |
| Weight                       | 3.7 kg                       |
| Tilt adjustment              | 135 degrees                  |
| Light Source                 | SMD 2835 LED array           |
| Operating Temperature        | -0°C to + 35°C               |
| Output power                 | 50 W                         |
| Light Output (luminous flux) | 5000 @ 1m (lumens)           |
| Fuse Rating                  | 13 A                         |
| Power Supply                 | 230V 50 Hz                   |
| Insulation Class             | II (with socket earth only)  |
| IP Rating                    | IP54                         |
| Energy Efficiency Class      | D                            |
| Efficacy                     | 172.5 Lm/W                   |
| Colour Temperature           | 6000 K                       |
| Weighted Energy Consumption  | 8 kWh/1000h                  |
| Life expectancy of LED       | 25,000 hours                 |

---

## **SAFETY PRECAUTIONS**

---

1. This worklight must **NOT** be immersed in water.
2. **DO NOT** look directly into the lamp when switched on as this can damage the eyes.
3. If used with an extension cable always ensure that the extension cable is fully unwound.
4. **DO NOT** use this worklight if it has a broken lens, casing or damaged cable.
5. **ALWAYS** unplug the worklight before moving it or performing maintenance. **DO NOT** touch the lamp when your hands are wet.
6. **DO NOT** attempt to disassemble or repair the worklight.
7. **DO NOT** leave the worklight unattended when switched on. **ALWAYS** unplug the worklight when it is not in use.
8. **NEVER** unplug by holding the cable. Unplug by holding the plug.
9. **NEVER** use the worklight if the cable or plug are damaged.
10. When erecting the tripod, ensure that the ground is level and firm.
11. Take extra care not to push or knock the tripod over when fully extended.
12. Ensure the lamp is a safe distance from other objects in the working space.

## **GUARANTEE**

This product is guaranteed against faulty manufacture for a period of 12 months from the date of purchase. Please keep your receipt which will be required as proof of purchase.

This guarantee is invalid if the product is found to have been abused or tampered with in any way, or not used for the purpose for which it was intended.

Faulty goods should be returned to their place of purchase, no product can be returned to us without prior permission. This guarantee does not effect your statutory rights.

## **ENVIRONMENTAL RECYCLING POLICY**



Through purchase of this product, the customer is taking on the obligation to deal with the WEEE in accordance with the WEEE regulations in relation to the treatment, recycling & recovery and environmentally sound disposal of the WEEE.

In effect, this means that this product must not be disposed of with general household waste. It must be disposed of according to the laws governing Waste Electrical and Electronic Equipment (WEEE) at a recognised disposal facility.

# ELECTRICAL CONNECTIONS



**WARNING! READ THESE ELECTRICAL SAFETY INSTRUCTIONS THOROUGHLY BEFORE CONNECTING THE PRODUCT TO THE MAINS POWER SUPPLY.**

Connect the mains lead to a standard, 230 Volt (50Hz) electrical supply through an approved BS 1363 plug, or a suitably fused isolator switch.

If the plug has to be changed because it is not suitable for your socket, or because of damage, it must be removed and a replacement fitted, following the wiring instructions shown below. The old plug must be discarded safely, as insertion into a power socket could cause an electrical hazard.



**WARNING: THE WIRES IN THE POWER CABLE OF THIS PRODUCT ARE COLOURED IN ACCORDANCE WITH THE FOLLOWING CODE:  
BLUE = NEUTRAL    BROWN = LIVE    YELLOW AND GREEN = EARTH**

If the colours of the wires in the power cable do not agree with the markings on the plug.

- The BLUE wire must be connected to the terminal marked N or coloured black.
- The BROWN wire must be connected to the terminal marked L or coloured red.
- The YELLOW AND GREEN wire must be connected to the terminal marked E or coloured green.

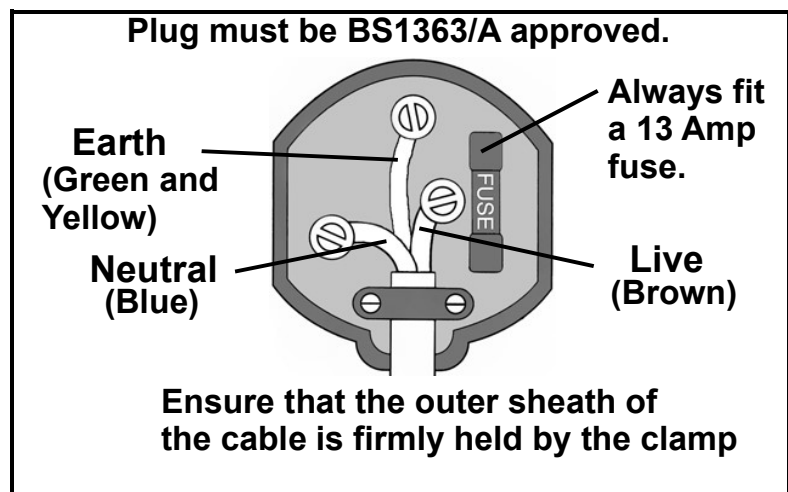

**We strongly recommend that this product is connected to the mains supply through a Residual Current Device (RCD)**

If in any doubt, consult a qualified electrician. DO NOT attempt any repairs yourself.



**This symbol indicates that the product is classified as a Class II component and does not require an earth connection. However, the 3-pin power socket is earthed.**

# COMPONENT PARTS

|   |                           |
|---|---------------------------|
| 1 | Light Tube                |
| 2 | Handle                    |
| 3 | On/Off Switch             |
| 4 | Light tube release button |
| 5 | Power outlet              |
| 6 | Cable winder              |
| 7 | Tripod leg locker         |

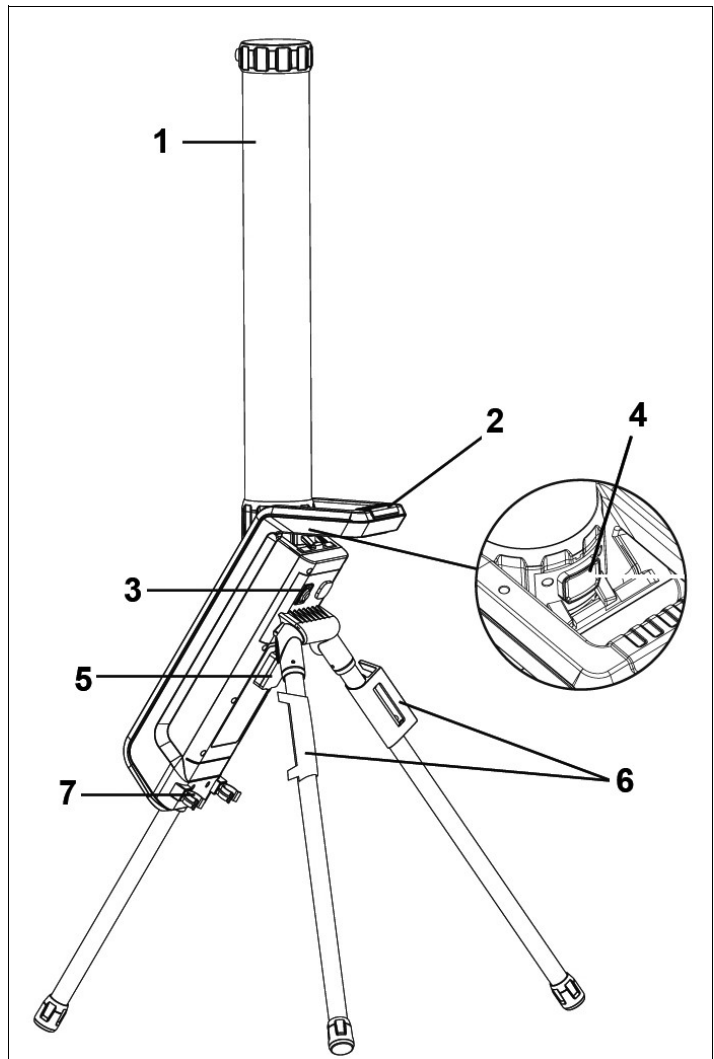

# ASSEMBLY & USE

Expand the tripod legs to the maximum degree.

Flip the light tube over to the vertical position.

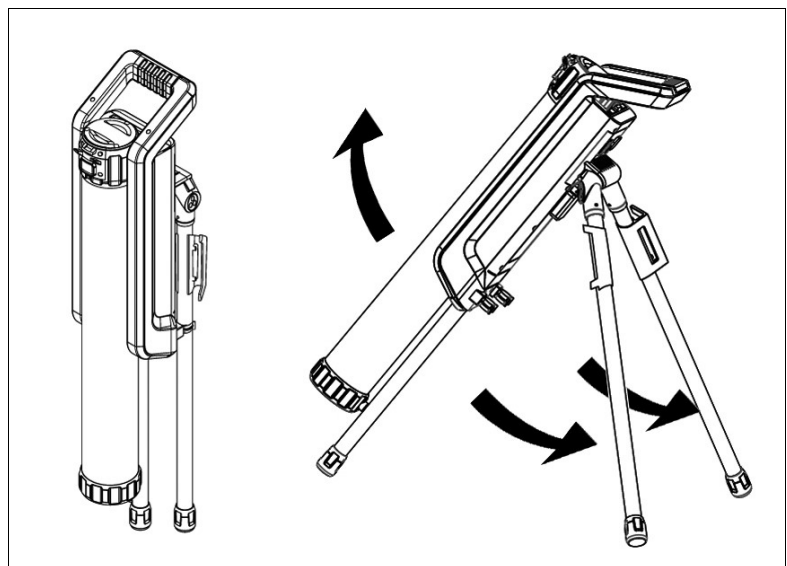

The automatic locking secures the light tube in this position.

Press and hold the light tube release button.

Fold down the light tube.

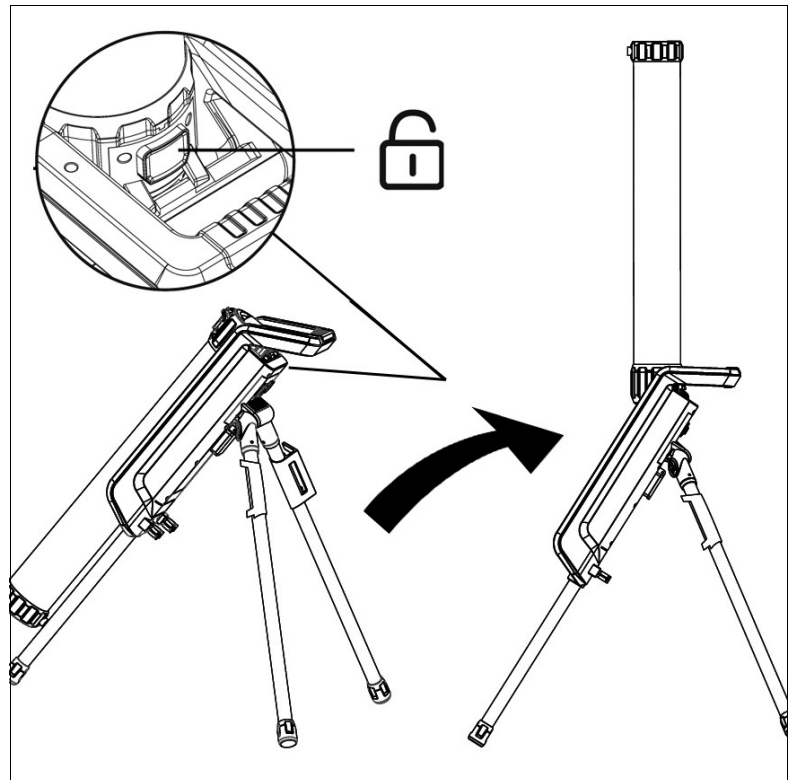

## CARE & STORAGE

1. When not in use, switch off & unplug from the power supply. Coil the cable around the storage hooks provided on the tripod for tidy storage.
2. Store this product in a secure, dry place, out of the reach of children. **DO NOT** leave it exposed to the elements and avoid direct sunlight, direct heat, rain/moisture etc.
3. Keep the external surfaces clean. Avoid impact damage & do not allow this product to come into contact with abrasive or corrosive materials.
4. **DO NOT** use solvents, thinners or alcohol for cleaning, as these chemicals will damage the finish. With the lamp unplugged from the power supply, use a dry cloth to wipe over the lamp components.
5. Only use extension leads that are of an appropriate power rating and suitable for the work environment. Inspect the extension lead regularly and replace if damaged.
6. The LED light source cannot be replaced but has a life expectancy of approximately 25000 hours.
7. **NEVER** use unauthorised accessories or attachments which can cause personal injury or damage to the product.
8. **DO NOT** attempt to repair or modify this product or attempt any electrical repair yourself. Consult the CLARKE Service Department on 020 8988 7400.

# DECLARATIONS OF CONFORMITY



Fitzwilliam Hall, Fitzwilliam Place, Dublin 2

## DECLARATION OF CONFORMITY

This is an important document and should be retained.

We hereby declare that this product(s) complies with the following legislation:

- 2009/125/EC Ecodesign Directive
- 2014/30/EU Electromagnetic Compatibility Directive
- 2014/35/EU Low Voltage Directive
- 2011/65/EU Restriction of Hazardous Substances (RoHS) Directive

The following standards have been applied to the product(s):

- EN IEC 61000-3-2:2019+A1:2021, IEC 62321-3-1:2013, IEC 62321-7-1:2015, IEC 62321-7-2:2017,
- EN IEC 55015:2019+A11:2020, IEC 62321-1:2013, IEC 62321-2:2013, IEC 62321-4:2013+A1:2017,
- EN 61000-3-3:2013+A1:2019, IEC 62321-5:2013, IEC 62321-6:2015, IEC 62321-8:2017,
- EN 61547:2009, EN 60598-1:2021+A11:2022, EN 62493:2015+A1:2022, EN 60598-2-4:2018

The technical documentation required to demonstrate that the product(s) meet(s) the requirement(s) of the aforementioned legislation has been compiled and is available for inspection by the relevant enforcement authorities.

The CE mark was first applied in: 2024

Product Description: Work Light  
Model Number(s): SMD5000  
Serial/Batch Number: Refer to product/packaging label  
Date of Issue: 08/05/2024

Signed:

J.A Clarke  
Director



Hemmall Street, Epping, Essex, CM16 4LG

## DECLARATION OF CONFORMITY

This is an important document and should be retained.

We hereby declare that this product(s) complies with the following legislation:

- The Ecodesign for Energy-Related Products Regulations 2010
- The Electromagnetic Compatibility Regulations 2016
- The Electrical Equipment (Safety) Regulations 2016
- The Restriction of the Use of Certain Hazardous Substances in Electrical and Electronic Equipment Regulations 2012

The following standards have been applied to the product(s):

- EN IEC 61000-3-2:2019+A1:2021, IEC 62321-3-1:2013, IEC 62321-7-1:2015, IEC 62321-7-2:2017,
- EN IEC 55015:2019+A11:2020, IEC 62321-1:2013, IEC 62321-2:2013, IEC 62321-4:2013+A1:2017,
- EN 61000-3-3:2013+A1:2019, IEC 62321-5:2013, IEC 62321-6:2015, IEC 62321-8:2017,
- EN 61547:2009, EN 60598-1:2021+A11:2022, EN 62493:2015+A1:2022, EN 60598-2-4:2018

The technical documentation required to demonstrate that the product(s) meet(s) the requirement(s) of the aforementioned legislation has been compiled and is available for inspection by the relevant enforcement authorities.

The UKCA mark was first applied in: 2024

Product Description: Work Light  
Model Number(s): SMD5000  
Serial/Batch Number: Refer to product/packaging label  
Date of Issue: 08/05/2024

Signed:

J.A Clarke  
Director

# A SELECTION FROM THE VAST RANGE OF

# Clarke®

## QUALITY PRODUCTS



**AIR COMPRESSORS**  
From DIY to industrial, Plus air tools, spray guns and accessories.

**GENERATORS**  
Prime duty or emergency standby for business, home and leisure.

**POWER WASHERS**  
Hot and cold, electric and engine driven - we have what you need

**WELDERS**  
Mig, Arc, Tig and Spot. From DIY to auto/industrial.

**METALWORKING**  
Drills, grinders and saws for DIY and professional use.

**WOODWORKING**  
Saws, sanders, lathes, mortisers and dust extraction.

**HYDRAULICS**  
Cranes, body repair kits, transmission jacks for all types of workshop use.

**WATER PUMPS**  
Submersible, electric and engine driven for DIY, agriculture and industry.

**POWERTOOLS**  
Angle grinders, cordless drill sets, saws and sanders.

**STARTERS/CHARGERS**  
All sizes for car and commercial use.



## PARTS & SERVICE: 0208 988 7400

**Parts Enquiries**  
[Parts@clarkeinternational.com](mailto:Parts@clarkeinternational.com)

**Servicing & Technical Enquiries**  
[Service@clarkeinternational.com](mailto:Service@clarkeinternational.com)

SALES: UK 01992 565333 or Export 00 44 (0)1992 565335

**Clarke® INTERNATIONAL** Hemnall Street, Epping, Essex CM16 4LG  
[www.clarkeinternational.com](http://www.clarkeinternational.com)